

- GRADING NOTES:**
- REFER TO THE SITE PLAN FOR RELATED NOTES.
 - ALL CONTOURS AND SPOT ELEVATIONS REFLECT FINISHED GRADES.
 - ALL ELEVATIONS ARE IN REFERENCE TO THE BENCHMARK WHICH MUST BE VERIFIED BY THE GENERAL CONTRACTOR PRIOR TO GROUND BREAKING.
 - ALL FILL TO BE COMPACTED TO 95% A.A.S.H.T.O. STANDARD COMPACTION. REFER TO THE SOILS REPORT FOR SITE PREPARATION, GRADING AND FILL REQUIREMENTS.
 - THE SITE CONTRACTOR SHALL PROTECT ALL TREES AND VEGETATION INDICATED TO REMAIN AND SHALL MAINTAIN ALL TREE PROTECTION BARRICADES.
 - THE CONTRACTOR SHALL BLEND NEW EARTHWORK SMOOTHLY WITH EXISTING CONTOURS.
 - THE PROPOSED CONTOURS SHOWN IN DRIVES, PARKING LOTS AND SIDEWALKS ARE FINISHED ELEVATIONS INCLUDING ASPHALT. REFER TO PAVEMENT CROSS-SECTION DATA TO ESTABLISH CORRECT SUB-BASE OR AGGREGATE BASE COURSE ELEVATIONS TO BE COMPLETED UNDER THIS CONTRACT.
 - ALL SLOPES MUST BE SEEDED AND MULCHED WITHIN 21 CALENDAR DAYS. ALL OTHER AREAS, 15 WORKING DAYS OR 90 CALENDAR DAYS WHICHEVER IS SHORTER. REFER TO THE EROSION CONTROL ORDINANCE FOR ADDITIONAL REQUIREMENTS.
 - NO EROSION CONTROL DEVICE MAY BE REMOVED UNTIL THE SITE IS STABILIZED.
 - THE CONTRACTOR SHALL IMMEDIATELY REPORT TO THE OWNER AND ENGINEER ANY DISCREPANCIES FOUND BETWEEN ACTUAL FIELD CONDITIONS AND CONSTRUCTION DOCUMENTS AND SHALL WAIT FOR INSTRUCTION PRIOR TO PROCEEDING WITH WORK.
 - ALL STORM DRAINAGE WITHIN THE RIGHT-OF-WAY SHALL BE CLASS III RCP OR GREATER AS SPECIFIED.
 - COMPACTION AND PLACEMENT OF FILL MATERIAL SHALL BE PER SOILS REPORT.
 - GRADING MORE THAN ONE ACRE WITHOUT AN APPROVED EROSION CONTROL PLAN IS A VIOLATION OF THE CITY/COUNTY EROSION CONTROL ORDINANCE AND IS SUBJECT TO A FINE.
 - A GRADING PLAN MUST BE SUBMITTED FOR ANY LOT GRADING EXCEEDING ONE ACRE THAT WAS NOT PREVIOUSLY APPROVED.
 - ALL "STD." NUMBERS REFER TO THE CHARLOTTE/MECKLENBURG LAND DEVELOPMENT STANDARDS MANUAL.
 - ON-SITE BURIAL PITS REQUIRE AN ON-SITE DEMOLITION LANDFILL PERMIT FROM THE ZONING ADMINISTRATOR.
 - PE SEALED SHOP DRAWINGS FOR RETAINING WALL MUST BE SUBMITTED TO CITY/COUNTY ENGINEERING DEPARTMENT PRIOR TO CONSTRUCTION.
 - SEE SHEET C804 FOR STORM DRAINAGE DESIGN DATA.

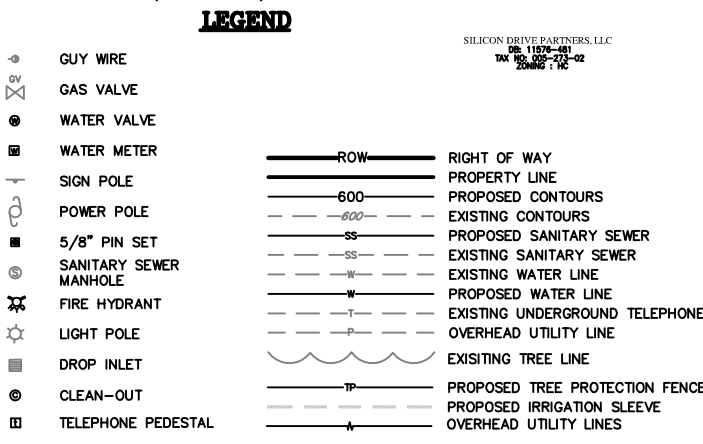

- GENERAL NOTES:**
- COORDINATE ALL CURB AND STREET GRADES IN INTERSECTION WITH INSPECTOR.
 - APPROVAL OF THIS PLAN IS NOT AN AUTHORIZATION TO GRADE ADJACENT PROPERTIES. WHEN FIELD CONDITIONS WARRANT OFF-SITE GRADING, PERMISSION MUST BE OBTAINED FROM THE AFFECTED PROPERTY OWNERS.
 - IN ORDER TO ENSURE PROPER DRAINAGE, KEEP A MINIMUM OF 0.5% SLOPE ON THE CURB.
 - SUBSURFACE DRAINAGE FACILITIES MAY BE REQUIRED IN THE STREET RIGHT-OF-WAY IF DETERMINED NECESSARY BY THE INSPECTOR.
 - STORM DRAINAGE MAY REQUIRE MODIFICATION BASED UPON FIELD CONDITIONS.
 - NON-STANDARD ITEMS (IE. PAVERS, IRRIGATION SYSTEMS, ETC.) IN THE RIGHT-OF-WAY REQUIRE A RIGHT-OF-WAY ENCROACHMENT AGREEMENT WITH THE (MECKLENBURG DEPARTMENT OF TRANSPORTATION/NORTH CAROLINA DEPARTMENT OF TRANSPORTATION) BEFORE INSTALLATION.
 - HIGH DENSITY POLYETHYLENE (HDPE) STORM DRAINAGE PIPE INSTALLED WITHIN EXISTING OR PROPOSED PUBLIC STREET RIGHT-OF-WAY MUST BE APPROVED BY THE CITY/COUNTY INSPECTOR PRIOR TO ANY BACKFILL BEING PLACED. BACKFILL MATERIAL MUST BE APPROVED BY THE CITY/COUNTY INSPECTOR PRIOR TO PLACEMENT OF THE MATERIAL WITHIN THE PUBLIC STREET RIGHT-OF-WAY. HDPE SHALL CONFORM TO THE REQUIREMENTS OF AASHTO SPECIFICATION M294 (LATEST EDITION) FOR CORRUGATED POLYETHYLENE PIPE.

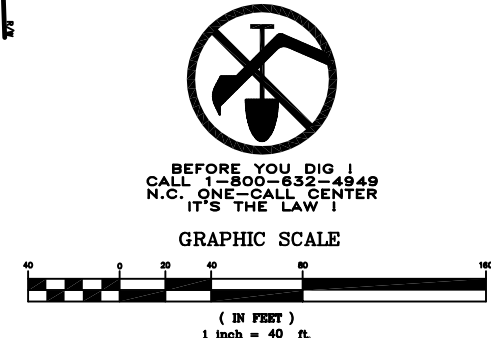

DATE	DESCRIPTION
05/18/06	PLAN SUBMISSION
07/11/06	REVISED PER MECKLENBURG COUNTY AND CORNELIUS COMMENTS. RESUBMITTED.
08/22/06	ADDED HIGH WATER TABLE DRAINS.
10/13/06	ADDED PAINT BOOTH AND REVISED GRADES AND STORM DRAINAGE.

CLIENT:
 MW ARK, LLC
 19401 OLD JETTON ROAD
 CORNELIUS, NC 28031
 (P) 704-987-0612 (F) 704-987-0767

DATE
 05/18/2006

WALTRIP RACING WORLD
 LIVERPOOL PARKWAY, CORNELIUS
 LEMLEY TWP., MECKLENBURG COUNTY, NC

GRADING & STORM DRAINAGE

JOB NUMBER: 848.20
 SHEET NUMBER: C400